

POSITION	A	B	C	D
15	16.33	25.00	30.80	2.29
26	24.66	33.30	39.20	2.29
44	38.38	47.10	53.10	2.29
62	54.84	63.50	69.40	2.41

### Specifications:

Current rating:3.0A AC,DC

Voltage rating:250V AC,DC

Temperature range:-40°C ~ +85°C

Contact resistance:30mohm max.

Insulation:5,000Mohm min.

Withstanding voltage:1,000V AC/Minute

### Materials:

Insulator:PBT Glass fiber 30%(UL94V-0)

Contact:Copper alloy Nickel Undercoated  
,Gold plated

Shell:Metal Iron with nickel plated

### HOW TO ORDER

5510-XXS-02A-01

01:GOLD PLATED

RIVET W/BOARD LOCK /HEX SCREW

S: FEMALE

NO. OF POSITIONS

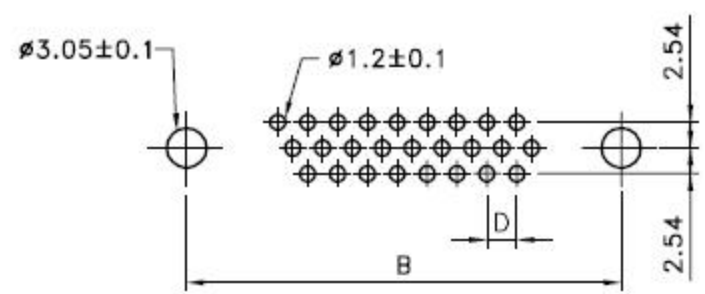
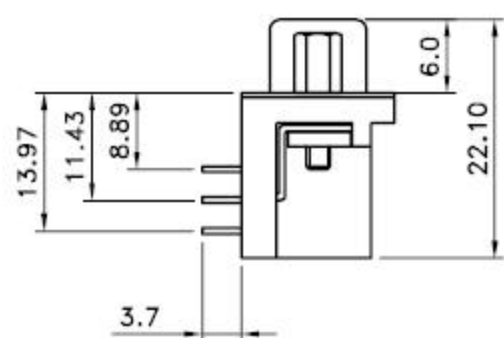
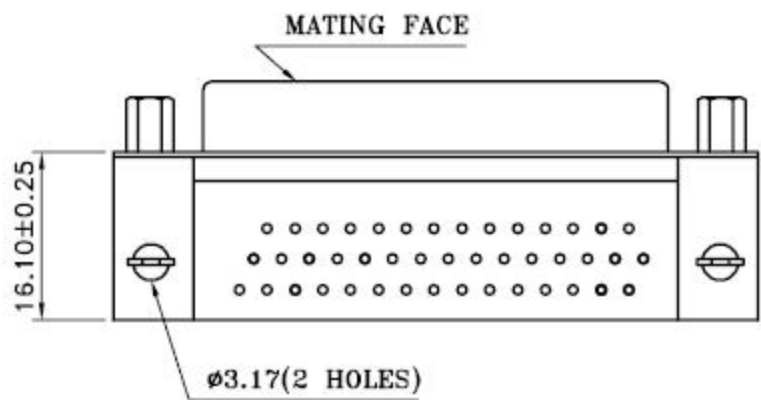
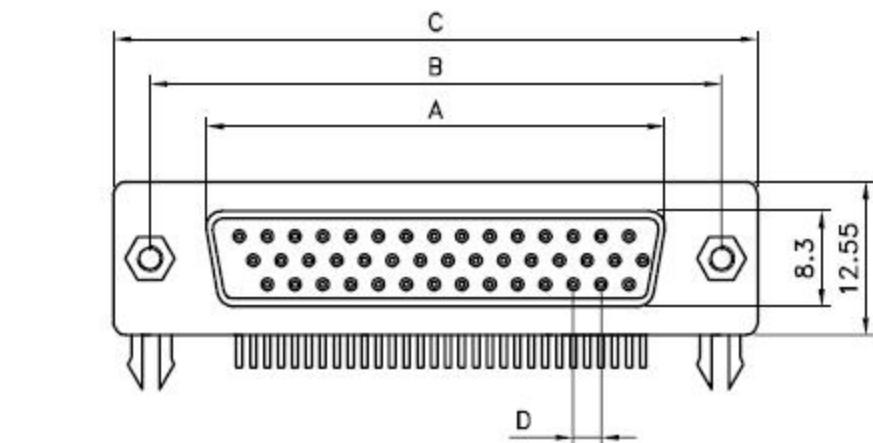

P.C.B. LAYOUT